

AUTOMATIC ENCLOSED EXTENSION REELS FOR HOSE

TF2K - TF3K

Compressed air, water

A white, semi-circular automatic enclosed extension reel (TF2K) mounted on a blue tiled wall. It features a black hose inlet on the left and a black hose outlet at the bottom. The reel is partially unrolled, showing the internal mechanism.

TF2K

APPLICATION

For workshops, maintenance services, building site, installers, etc...

- Extend the life-span of hose
- Ensure the safety of personnel
- Eliminate dangerous hose on the floor
- Avoid knotting of hose
- Protect hoses and tools from impact damage

CONSTRUCTION

- Steel casing on TF3K
- ABS casing on TF2K
- Fited with swivel brackets
- Internal roller guide
- Rotary joint
- Working pressure up to 15 bar, depending on the model
- Rewind springs housed internally
- Ratchet and adjustable hose stop
- Epoxy paint finish on the TF3K

A blue, cylindrical automatic enclosed extension reel (TF3K) mounted on a blue tiled wall. It features a black hose inlet on the left and a white hose outlet at the bottom. The reel is partially unrolled, showing the internal mechanism.

TF3K

Enclosed model

TF2K model

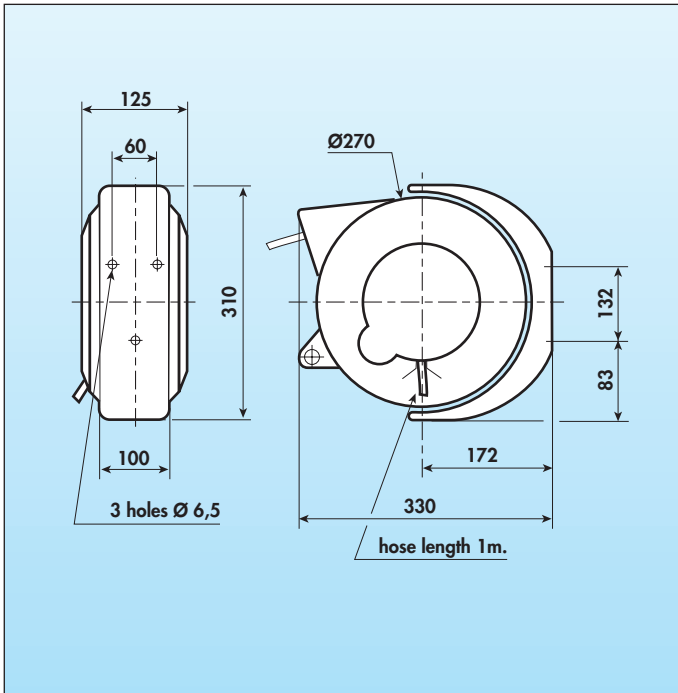

TF3K model

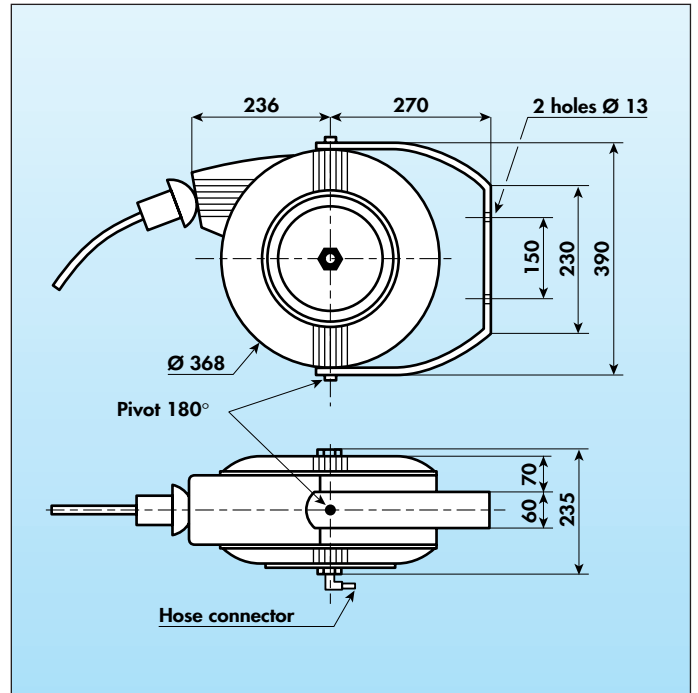

MODELS AND CAPACITIES

Application	Models	Capacities					Weight in Kg	Replacement spring S (R) = Series L = extended
		Int./ext - diameter	Temp.	Pressure (bar)	Length in m	Hose connector		
COMPRESSED AIR	TF2K 061211 AC	6 x 12	60°	12	11	not fitted	4	-
	TF2K 081510 AC	8 x 15	60°	12	10	not fitted	4	-
COMPRESSED AIR, WATER	TF3K 071310 AC/EA	7 x 13	60°	15	10	not fitted	19	(1S) 4 3R45 015
	TF3K 071315 AC/EA	7 x 13	60°	15	15	not fitted	20	(1L) 4 3 R45 028
	TF3K 071320 AC/EA	7 x 13	60°	15	20	not fitted	21	(2S) 4 3 R45 015
	TF3K 091612 AC/EA	9 x 16	60°	15	12	not fitted	21	(1L) 4 3 R45 028
	TF3K 101710 AC/EA	10 x 17	60°	15	10	not fitted	20	(1S) 4 3 R45 015

IDENTIFICATION

Example: TF3K 091612 AC/EA

Reel fitted with ratchet, equipped with 12 m of compressed air/water hose of diameter 9 x 16 mm

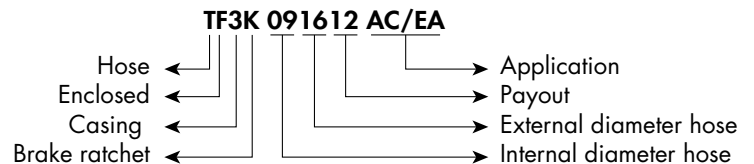

AUTOMATIC OPEN EXTENSION REELS FOR ELECTRICAL CABLE

LO2K - LO3K - LO4K



LO2K



LO3K



LO4K

APPLICATION

For workshops, maintenance services, building sites, installers...

- Extend power closer to work area
- Extend the life-span of your cables
- Ensure the safety of personnel
- Avoid knotting of cables

CONSTRUCTION

- Steel drum body
- Fitted with standard H07 RNF cable
- Fixed bracket
- Adjustable roller cable guides on LO3K and LO4K
- On model LO2K, 16A slipring fitted in steel housing, max. voltage 440 V ac / 220 V dc
- On model LO3K, 24-50A slipring fitted in polypropylene or steel housing, max. voltage 500V ac / dc
- On model LO4K, 24-50A slipring fitted in steel housing, max. voltage 500 V ac / dc
- Level of protection: IP 55
- Rewind springs housed internally
- Ratchet and adjustable cable stop
- Epoxy paint finish

OPTIONS

- Swivel brackets on all models

Open Model

LO2K Model

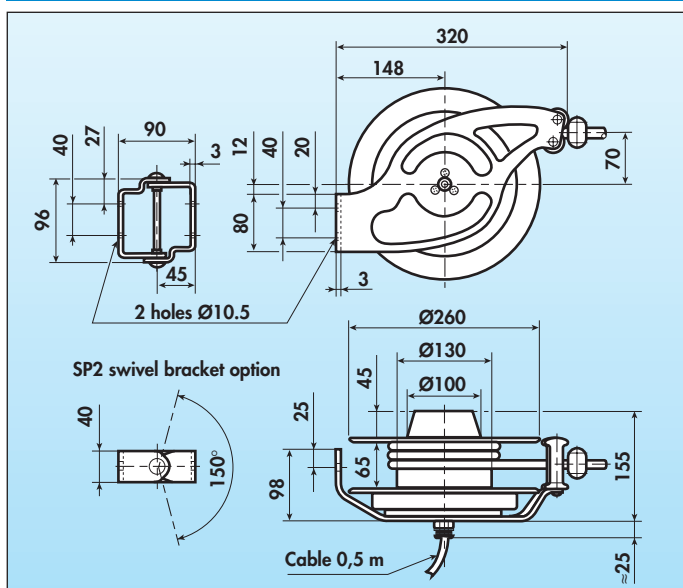

LO3K Model

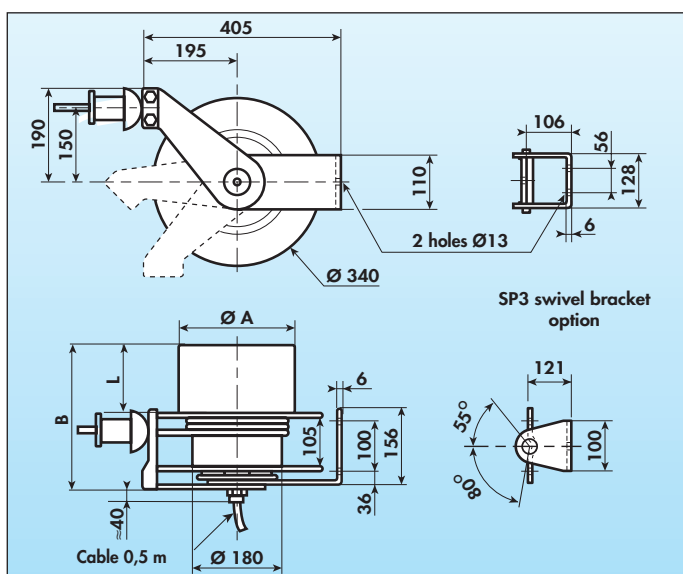

LO4K Model

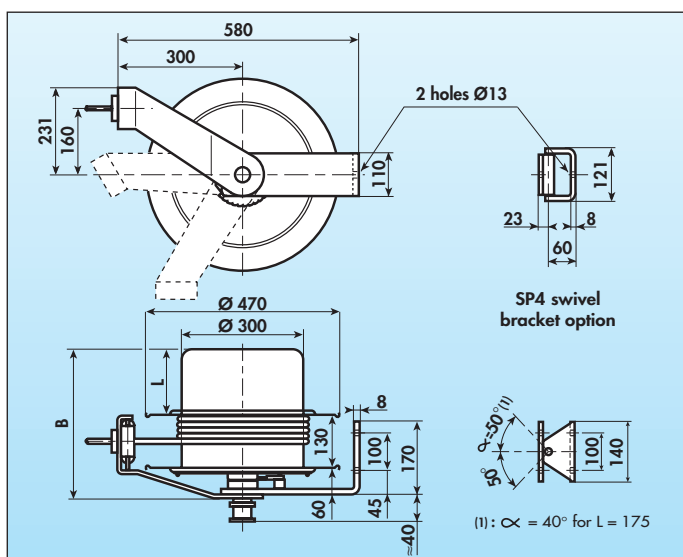

MODELS AND CAPACITIES

Models	Number of cores	A* max.	Length in m	A	B	L	Weight in Kg	Type of replacement spring S(R) = series L = Extended
LO2K 031512 RN	3G1,5	12 A	12	—	—	—	7,5	(1S) 4 3 20F 034
LO3K 031516 RN	3G1,5	16 A	16	234	225	78	18	(1L) 4 3 R45 028
LO3K 031520 RN	3G1,5	16 A	20	234	225	78	19	(2S) 4 3 R45 015
LO2K 041512 RN	4G1,5	12 A	12	—	—	—	8	(1S) 4 3 20F 034
LO3K 041516 RN	4G1,5	16 A	16	234	225	78	19	(1L) 4 3 R45 028
LO3K 041520 RN	4G1,5	16 A	20	234	225	78	20	(2S) 4 3 R45 015
LO2K 051512 RN	5G1,5	12 A	12	—	—	—	8,5	(1S) 4 3 20F 034
LO3K 051520 RN	5G1,5	16 A	20	234	290	145	20	(2S) 4 3 R45 015
LO4K 051525 RN	5G1,5	16 A	25	—	335	125	27	(1S) 4 3 R45 018
LO3K 071520 RN	7G1,5	12 A	20	220	285	140	22	(2S) 4 3 R45 015
LO4K 121515 RN	12G1,5	9 A	15	—	410	175	29	(1SR) 4 3 R45 026
LO2K 032512 RN	3G2,5	16 A	12	—	—	—	8,5	(1S) 4 3 20F 034
LO3K 032516 RN	3G2,5	24 A	16	234	225	78	19	(1L) 4 3 R45 028
LO3K 032520 RN	3G2,5	24 A	20	234	225	78	20	(2S) 4 3 R45 015
LO2K 042510 RN	4G2,5	16 A	10	—	—	—	8,5	(1S) 4 3 20F 034
LO3K 042516 RN	4G2,5	24 A	16	234	225	78	20	(1L) 4 3 R45 028
LO3K 042520 RN	4G2,5	24 A	20	234	225	78	21	(2S) 4 3 R45 015
LO4K 042525 RN	4G2,5	24 A	25	—	335	125	28	(1S) 4 3 R45 018
LO3K 052513 RN	5G2,5	24 A	13	234	290	145	20	(1L) 4 3 R45 028
LO4K 052520 RN	5G2,5	24 A	20	—	335	125	28	(1S) 4 3 R45 018
LO4K 072515 RN	7G2,5	16 A	15	—	335	125	29	(1S) 4 3 R45 018
LO3K 040415 RN	4G4	34 A	15	220	285	140	22	(2S) 4 3 R45 015
LO4K 040615 RN	4G6	44 A	15	—	335	125	29	(1SR) 4 3 R45 026
LO4K 050420 RN	5G4	34 A	20	—	410	175	30	(1SR) 4 3 R45 026
LO4K 050620 RN	5G6	44 A	20	—	410	175	31	(1SR) 4 3 R45 026

RN - Standard H07 RNF electrical cable

* Amperage indicated is for fully unwound cable

IDENTIFICATION

Example: LO3K 041516 RN

Open reeling drum with ratchet, fitted with 16 m
4 G 1,5 H 07 RNF cable

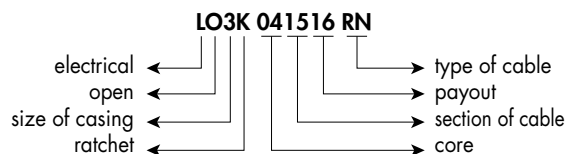

AUTOMATIC ENCLOSED EXTENSION REELS FOR ELECTRICAL CABLE

LF2K - LF3K



LF2K



LF3K

APPLICATION

For workshops, maintenance services, building sites, installers...

- Extend power closer to work area
- Extend the life-span of your cables
- Ensure the safety of personnel
- Avoid knotting of cables

CONSTRUCTION

- Steel sheet casing on LF3K model
- ABS casing on LF2K model
- Fitted with H07 RNF or H05 VVF cable
- Complete with swivel brackets
- Roller cable guides on LF2K and LF3K models
- 500V ac/dc – 30A slipring on LF3K model, in a polypropylene housing
- Level of protection: IP42 on LF2K and IP 55 on LF3K
- Rewind springs housed internally
- Ratchet and adjustable cable stop
- Epoxy paint finish on LF3K

Enclosed Model

LF2K Model

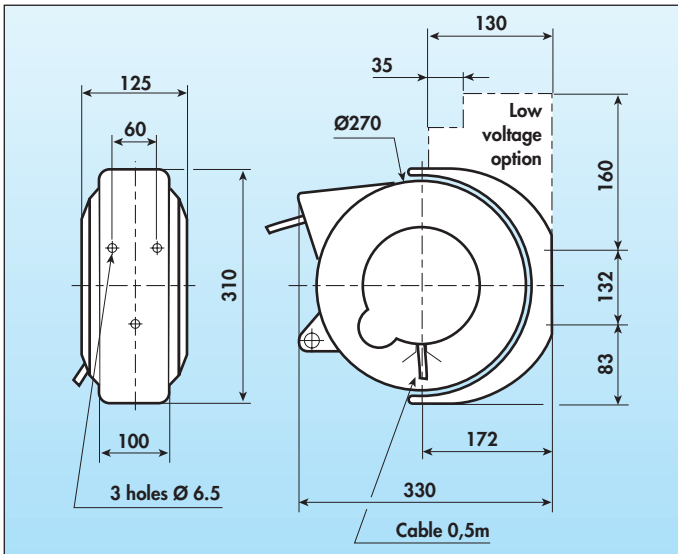

MODELS AND CAPACITIES

Models	Capacities			Weight in Kg	Type of replacement spring S = series L = Extended
	Number of cores/section	A* max.	length in m		
LF2K 030114 VV	3 G 1	5 A	14	4	—
LF2K 020116 VVB (A)	2x1	6 A	16	4	—
LF2K 020116 VVT (A+B)	2x1	6 A	16	6	—
LF2K 031512 VV	3 G 1,5	6 A	12	4	—
LF2K 032508 VV	3 G 2,5	10 A	8	4	—

LF3K 031515 RN	3 G 1,5	16 A	15	23	(1L) 4 3 R45 028
LF3K 031520 RN	3 G 1,5	16 A	20	24	(2S) 4 3 R45 015
LF3K 041515 RN	4 G 1,5	16 A	15	25	(1L) 4 3 R45 028
LF3K 041520 RN	4 G 1,5	16 A	20	26	(2S) 4 3 R45 015
LF3K 032516 RN	3 G 2,5	24 A	16	24	(1L) 4 3 R45 028
LF3K 032520 RN	3 G 2,5	24 A	20	25	(2S) 4 3 R45 015
LF3K 042515 RN	4 G 2,5	24 A	15	25	(1L) 4 3 R45 028

LF3K Model

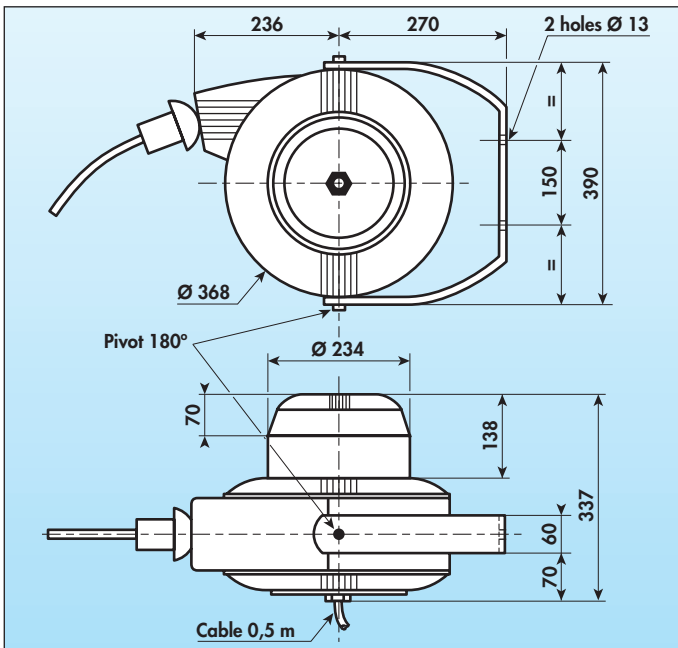

VV - Standard H05 VVF electrical cable

RN - Standard H07 RNF electrical cable

(A) - Reel fitted with hand lamp handle incorporating on/of switch and galvanized lamp cover

(B) - Extension reel with 230 V – 24 V transformer, protected by 2.5 A fuse

* Amperage indicated is for fully unwound cable

IDENTIFICATION

Example: LF3K 0416 1515 RN

Enclosed reeling drum with ratchet, fitted with 15 m 4 C 1.5 H 07 RNF cable

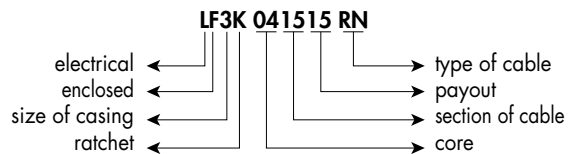

EARTH BONDING REELS

MALT

MT2K - MT3K

MF3K

MO2K

MO3K - MO4K + 100A safety clamp option

APPLICATION

To provide a temporary earthing connection:

- Either for the elimination of electrostatic charges (e.g. fuel supply vehicles)
- Or to provide protection to individuals by removing fault currents (e.g. mobile generators)

CONSTRUCTION

- Robust steel construction
- Swivel model with metal pivot or fixed model supplied with fixings manufactured from insulating material
- Roller guide
- Rewind springs housed internally
- Ratchet and adjustable cable stop
- EPOXY paint finish
- Single core, flexible durable cable with PVC green/yellow sheath

DESCRIPTION

- For electrostatic charges, a section of 4mm² or 6mm² is sufficient
- For the protection of individuals, refer to table 1 – Article 5.2 of norm EN 60204, below.

Installation PHASE conductor section (mm ²)	EARTH conductor section
$S \leq 16$	S
$16 < S \leq 35$	16
$S > 35$	S/2

INSTALLATION

- Our reels are delivered assembled and ready for use. They simply require attachment to a vertical support and then the necessary cable connections need to be made
- Terminals are used to connect the cable to the reel
- Connections at the ends of the cable:
 - electrostatic charges: by 100A petroleum clamp, in conformity to NFN88070 – passed on 09/11/1972
 - protection of individuals: by terminal (clip at the end of the cable to be unwound)
- In accordance with the intended usage, please refer to the instructions

OPTIONS

- Self-opening, 100A safety clamp
- Swivel brackets on open models

Enclosed model

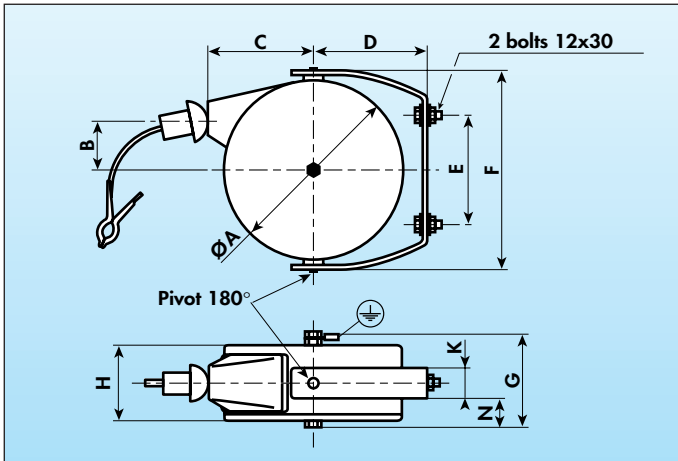

DIMENSIONS

	ØA	B	C	D	E	F	G	H	K	N
MT2K	196	53	110	135	100	230	145	118	30	56
MT3K	303	88	160	208	220	340	184	157	40	73
MF3K	368	105	236	219	150	390	215	195	60	70

MODELS AND CAPACITIES

Model	Cable			Weight in Kg	Replacement spring S = series
	Section	Outside diameter (D/d)	Length		
MT2K 010410 MA	1 x 4 mm ²	7,5 mm	10 m	10	(2S) 101 900
MT3K 010415 MA	1 x 4 mm ²	7,5 mm	15 m	19	(2S) 115 141
MT3K 011012 MA	1 x 10 mm ²	10,5 mm	12 m	22	(2S) 115 141
MF3K 011022 MA	1 x 10 mm ²	10,5 mm	22 m	25	(2S) 4 3 R45 015
MF3K 012520 MA	1 x 25 mm ²	13,5 mm	20 m	25	(2S) 4 3 R45 015

Open model

MO2K Model

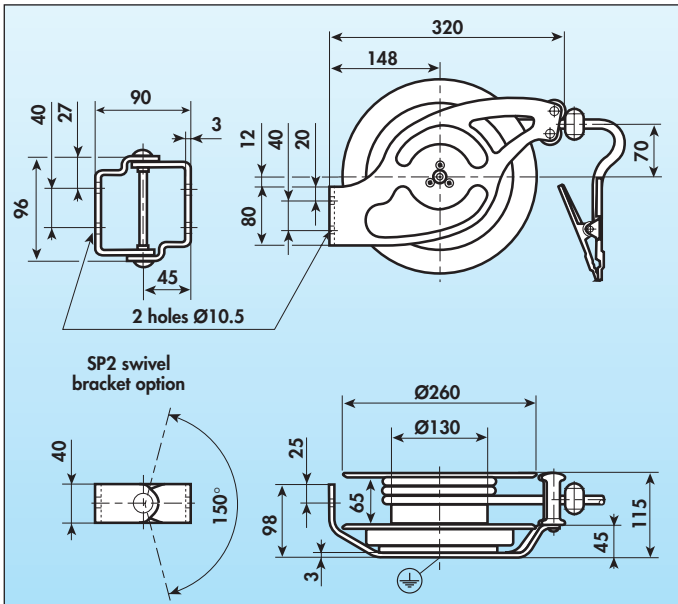

MO3K Model

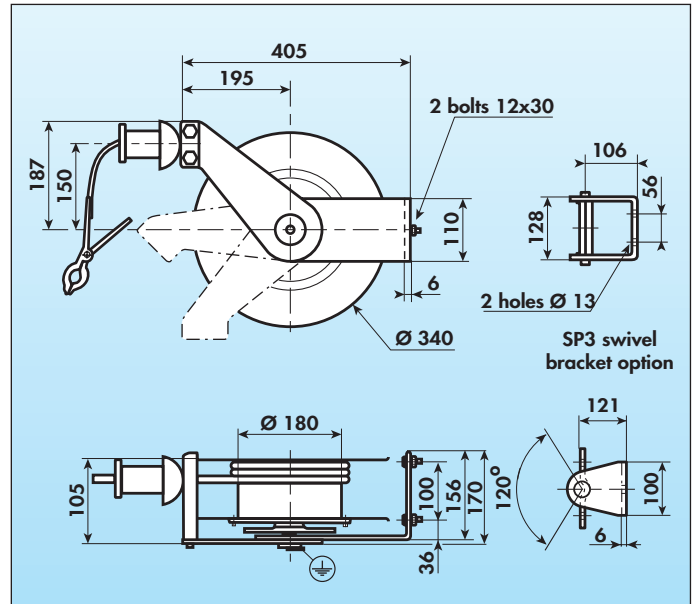

MO4K Model

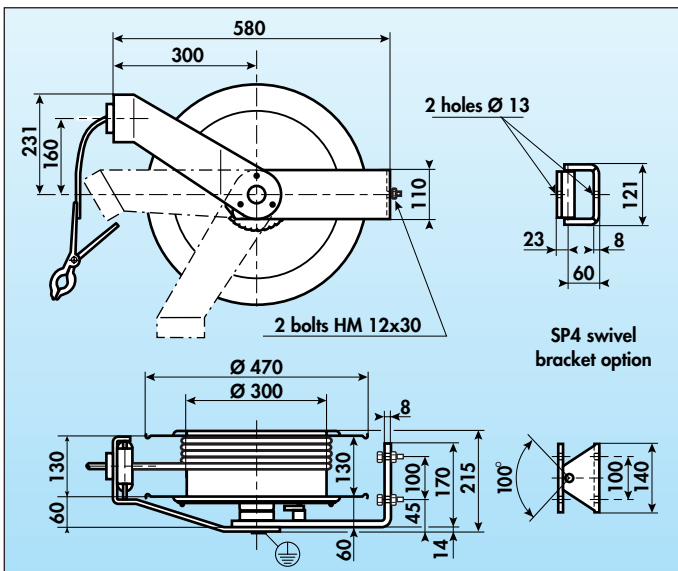

MODELS AND CAPACITIES

Model	Cable			Weight in Kg	Replacement spring S (R) = Series P = Parallel
	Section	Outside diameter (D/d)	Length		
MO2K 010612 MA	1 x 6 mm ²	9,5 mm	12 m	7	(1S) 4 3 20F 034
MO3K 011022 MA	1 x 10 mm ²	10,5 mm	22 m	12	(2S) 4 3 R45 015
MO4K 011030 MA	1 x 10 mm ²	10,5 mm	30 m	25	(2S) 4 3 R45 018
MO3K 012520 MA	1 x 25 mm ²	13,5 mm	20 m	17	(2S) 4 3 R45 015
MO4K 012525 MA	1 x 25 mm ²	13,5 mm	25 m	30	(2P) 4 3 R45 018
MO4K 013520 MA	1 x 35 mm ²	15,5 mm	20 m	30	(1SR) 4 3 R45 026

IDENTIFICATION

Example: MT2K 01 04 10 MA

Reel fitted with 10 m of 1 x 4mm² earthing cable

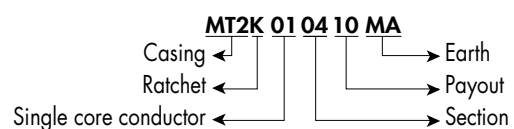

INDUSTRIAL REELING DRUMS WITH ELECTRICAL CABLE FOR MOBILE MACHINES

EXEL

To power and control mobile machines (overhead cranes, hoists, gantry cranes, lighting rigs, etc.).



EXEL 1



EXEL 2 + SE/BR



EXEL 2 + SP

APPLICATION

- To supply power and control to mobile industrial machinery
- Installation can be to a fixed point or to a mobile piece of machinery, and the cable can be supported or unsupported, with cable retrieve or vertical rewind.

CONSTRUCTION

- Steel drum body
- Mounted on permanently sealed roller bearings
- Advanced technology incorporating an automatic spring release and return system
- Slipping installed in steel external housing
- Easy access for maintenance purposes

PROTECTION

- Varnished, zinc-plated finish, all internal parts treated
- Level of protection: IP 55
- Profiled gland and seal system

OPTIONS

- Fixed bracket, roller guide and swivel bracket (Epoxy paint finish)

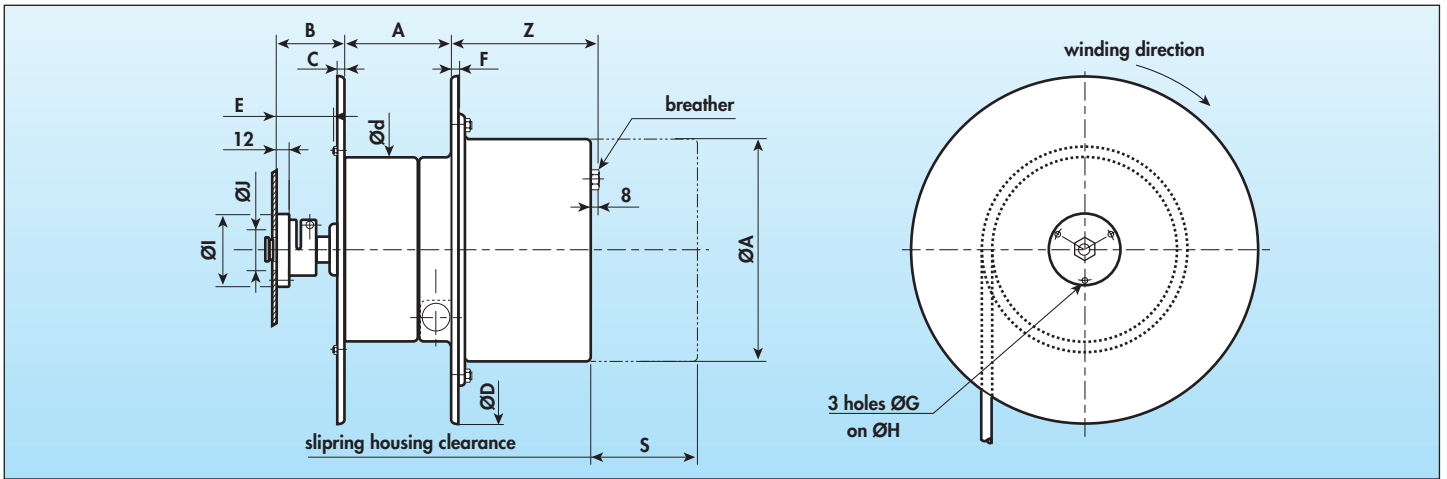

General dimensions of the standard flange model

	drum						mounting flange				weight in kilos	slipping type												
	ØD	Ød	A	B	C	E	F	ØG	ØH	ØI		ØJ	3TC8 (24A)			6TC8 (24A)			11TC8 (24A)			3TP050 (50A)		
													ØA	Z	S	ØA	Z	S	ØA	Z	S	ØA	Z	S
EXEL 1	340	180	105	66	6	53	11	7	60	70	40	14	234*	82	71	220	144	125	—	—	—	220	144	125
EXEL 2	390	220	115	84	10	57	17	9	90	108	50	16	220	150	125	—	—	—	220	225	200	—	—	—

Dimensions of options (SE, SE/BR and SP)

	K	L	M	N	O	P	Q	R	T	U	V	W	X	weight in kilos		
														SE	SE/BR	SP**
														EXEL 1	384	120
EXEL 2	431	125	180	35	100	52	236	153	150	249	300	43	80	3,5	6	10

* polypropylene housing without breather
 ** Includes SE/BR

Fixed bracket option (SE)

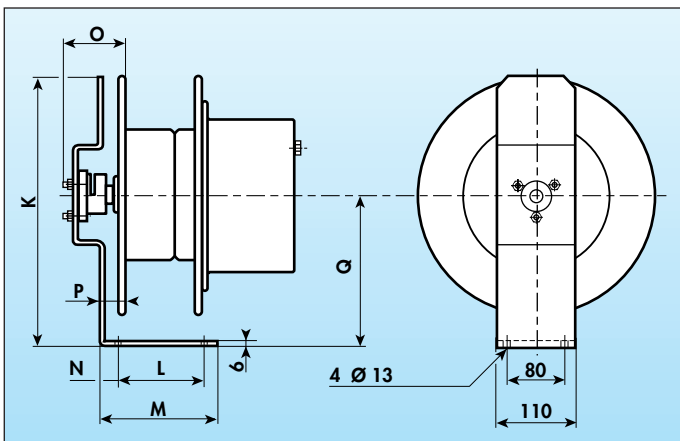

Swivel bracket option (SP)

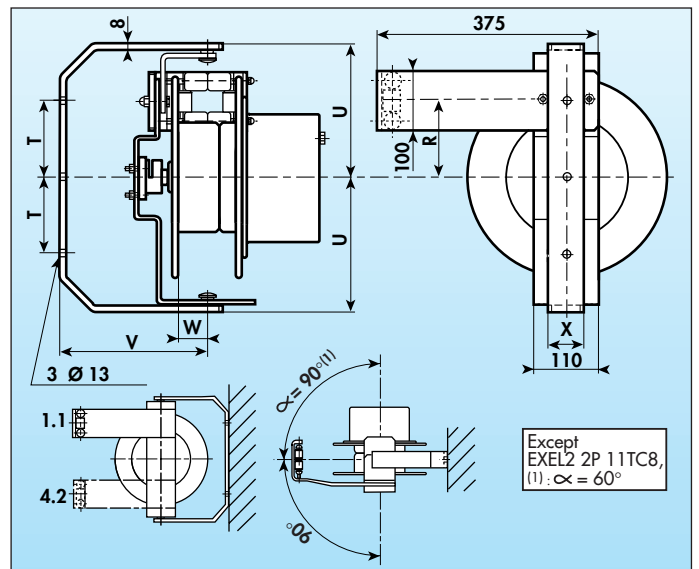

Fixed bracket option with roller guide (SE/BR)

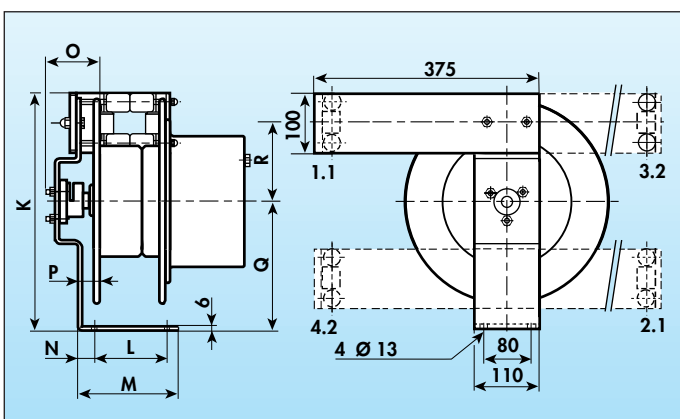

IDENTIFICATION

Example: EXEL 2 2SR 3TC8 042521 GPM NA=6 with flange
 Fitted with GPM – 21m 4 C 2.5² cable

- Type **EXEL2 2 SR 3 TC8 04 25 21 GPM NA=6**
- Number of springs
- Spring mounting / Series / Parallel
- Type of spring / Reinforced / Extended
- Slipping – number of phase rings
- Earth ring
- Core
- Number of cores
- Section of cable
- Payout
- Cable type
- Number of pre-turns

RETRACTABLE BARRIER REELS

P.N.



Sample 20 PN 12

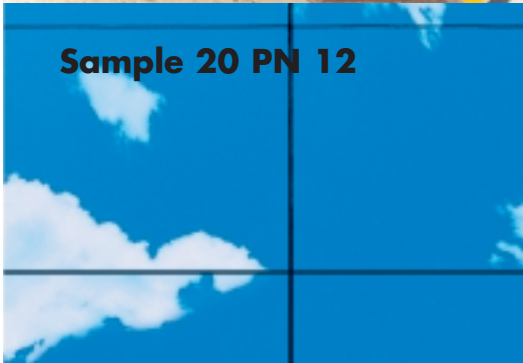

Sample 14 mtr Pit kit

APPLICATION

- For road, rail, work-site, factory, airports, etc.

CONSTRUCTION

- Steel casing
- A water repellent material banner, made up of vertical red and white alternate bands, is held up by a steel rope and runner, using the rings attached
 - One end of the banner is fixed to the reel, the other to a handle
- Rewind is by internally housed springs
- Epoxy paint finish

OPTIONS

- Banner reflectors

RETRACTABLE BARRIER REELS

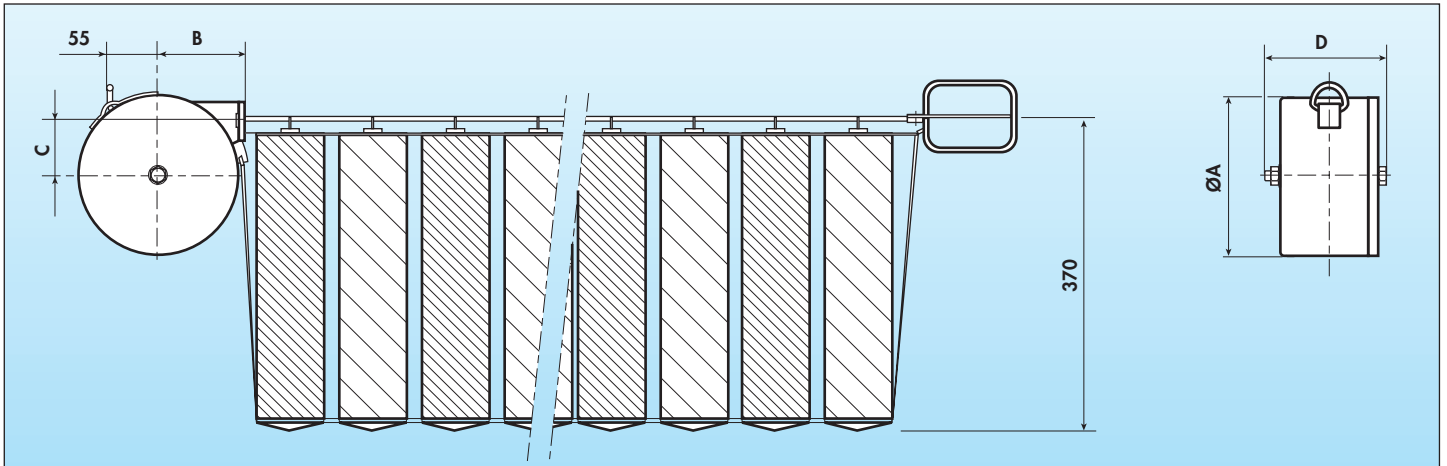

CAPACITY AND WEIGHT

Model	Banner length	Wire rope		Weight in Kg	Spare spring type S = series
		length	dia.		
20 PN 12 (R)	12 m	13 m	2,5 mm	7	(2S) 101029
20 PN 14 (R)	14 m	15 m	2,5 mm	7	(2S) 101029
30 PN 16 (R)	16 m	17 m	4 mm	15	(2S) 115141

DIMENSIONS

Model	A	B	C	D
20 PN 12	193	210	53	145
20 PN 14	193	210	53	145
30 PN 16	303	312	88	184

PIT KITS

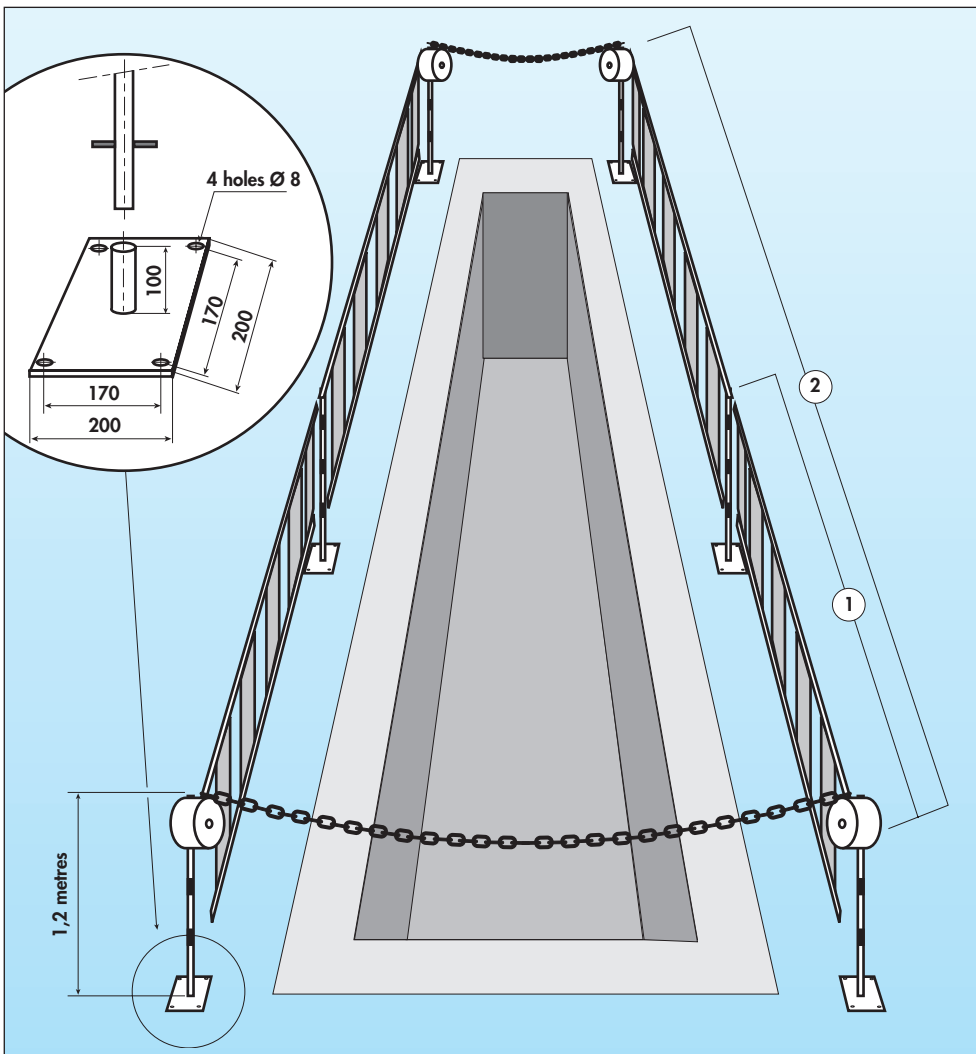

1 - PIT KIT 14 Metres

Comprising:

- 2 x 14m barrier reels
- 4 poles
- 4 plates
- 2 x 2.5m of red and white plastic chain
- 18 screws, 18 pegs, 18 washers
- 1 assembly drawing

2 - PIT KIT 28 Metres

Comprising:

- 4 x 14m barrier reels
- 6 poles
- 6 plates
- 2 x 2.5m of red and white plastic chain
- 26 screws, 26 pegs, 26 washers
- 1 assembly drawing